

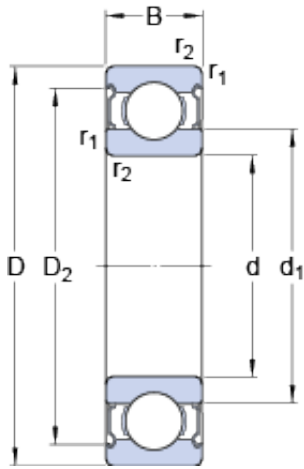

BEARING BOWER CORP.



25 mm x 47 mm x 12 mm 802023 Bearings
355.6x482.6x269.875mm

Bearing No. 6005-2Z

6005-2Z Bearing 2D drawings and 3D CAD models

Size	47x25x12 mm
Bore Diameter	47 mm
Outer Diameter	25 mm
Width	12 mm
d	25 mm
D	47 mm
B	12 mm
d ₁	32 mm
D ₂	42.2 mm
r _{1,2} - min.	0.6 mm
d _a - min.	28.2 mm
d _a - max.	31.9 mm
D _a - max.	43.8 mm
r _a - max.	0.6 mm
Basic dynamic load rating - C	11.9 kN
Basic static load rating - C ₀	6.6 kN
Fatigue load limit - P _u	0.275 kN
Reference speed	32000 r/min
Limiting speed	16000 r/min
Calculation factor - k _r	0.025
Calculation factor - f ₀	14
Category	Single Row Ball Bearings
Inventory	0.0
Manufacturer Name	SKF



BEARING BOWER CORP.

Minimum Buy Quantity	N/A
Weight / Kilogram	0.087
EAN	7316570646443
Product Group	B00308
Enclosure	2 Metal Shields
Precision Class	ABEC 1 ISO P0
Maximum Capacity / Filling Slot	No
Rolling Element	Ball Bearing
Snap Ring	No
Internal Special Features	No
Cage Material	Steel
Internal Clearance	C0-Medium
Inch - Metric	Metric
Long Description	25MM Bore; 47MM Outside Diameter; 12MM Outer Race Diameter; 2 Metal Shields; Ball Bearing; ABEC 1 ISO P0; No Filling Slot; No Snap Ring; No Internal Special Features
Category	Single Row Ball Bearing
UNSPSC	31171504
Harmonized Tariff Code	8482.10.50.68
Noun	Bearing
Keyword String	Ball
Manufacturer URL	http://www.skf.com
Manufacturer Item Number	6005-2Z
Weight / LBS	0.19
Bore	0.984 Inch 25 Millimeter
Outside Diameter	1.85 Inch 47 Millimeter
Outer Race Width	0.472 Inch 12 Millimeter
d ₁	32 mm
D ₂	42.2 mm



BEARING BOWER CORP.

$r_{1,2}$ min.	0.6 mm
d_a min.	28.2 mm
d_a max.	31.9 mm
D_a max.	43.8 mm
r_a max.	0.6 mm
Basic dynamic load rating C	11.9 kN
Basic static load rating C_0	6.55 kN
Fatigue load limit P_u	0.275 kN
Calculation factor k_r	0.025
Calculation factor f_0	14
Mass bearing	0.083 kg